

**SWIT®**

S-4600 SDI to HDMI converter

# USER MANUAL

SWIT Electronics Co., Ltd.

Tel:+86-25-85805753  
Fax:+86-25-85805296  
<http://www.swit.cc>  
E-mail: [contact@swit.cc](mailto:contact@swit.cc)

## 1. Characteristics

- ◆ Portable 3G/HD/SD-SDI to HDMI converter
- ◆ 1 SDI input, 1 SDI loop through output, 1 HDMI output,
- ◆ Embed SDI audio to HDMI output
- ◆ SDI embedded audio output (3.5mm socket)

## 2. Product View

Left side view

Front view

Right side view

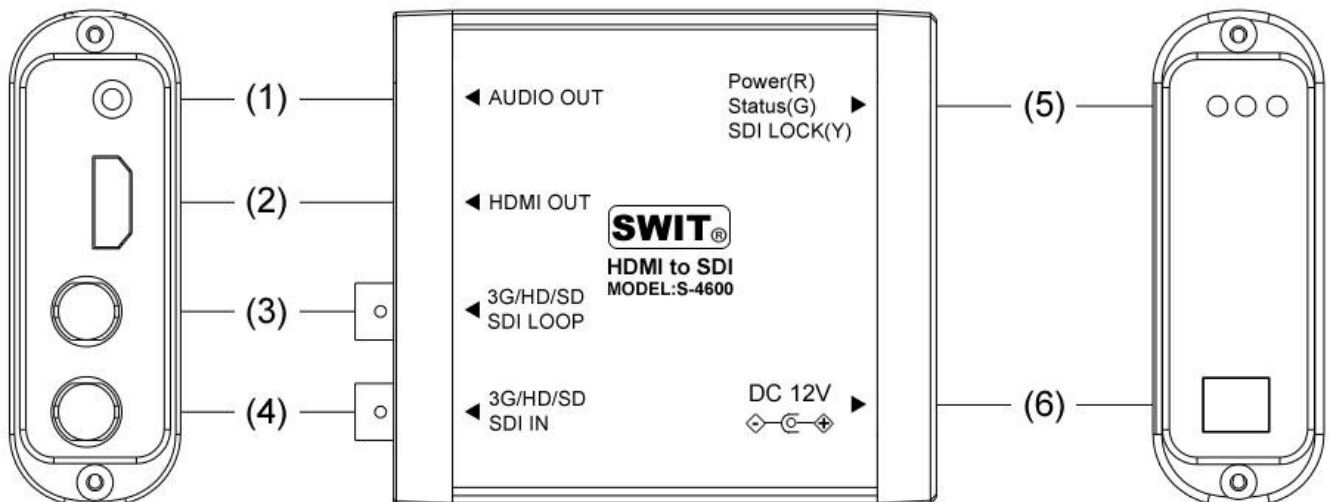

- (1) **AUDIO OUT:** Analog audio output (3.5mm)
- (2) **HDMI OUT:** HDMI output
- (3) **SDI LOOP:** 3G/HD/SD-SDI loopthrough output (BNC)
- (4) **SDI IN:** 3G/HD/SD-SDI input (BNC)
- (5) **LED status indicator**
- (6) **DC 12V:** 5.5mm pole DC input

### 3. Installation Plate

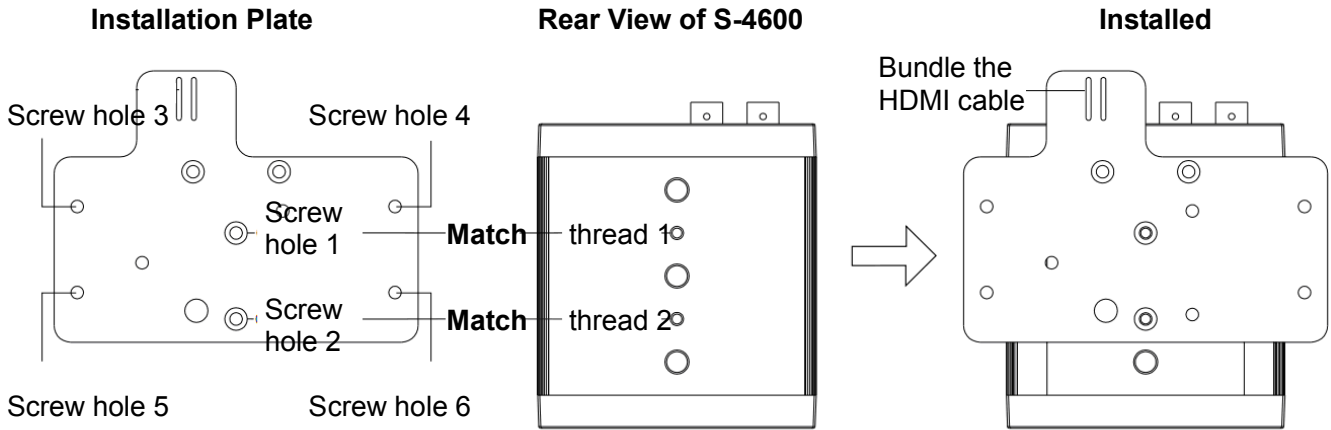

Match the screw holes 1&2 with the threads 1&2 of S-4600, and fix the installation plate to the S-4600 by the supplied screws. HDMI cable can be bundled onto the installation plate. The screw holes 3, 4, 5, 6 are used to install S-4600 to wall or racks.

### 4. Indicators and Switchers

- (1) Power (Red): Power indicator
- (2) Status (Green): Status indicator, lights on when there's HDMI output and connected to HDMI input devices in well condition.
- (3) SDI LOCK (Yellow): SDI indicator, lights on when there's SDI input recognized.

### 5. Specifications

Input	3G/HD/SD-SDI×1		
Output	3G/HD/SD-SDI×1, HDMI×1, Analog audio (3.5mm)×1		
Video Format	HDMI	480i / 576i / 720p (60 / 59.94 / 50) / 1080i (60 / 59.94 / 50) / 1080p (60 / 59.94 / 50 / 30 / 29.97 / 25 / 24 / 23.98)	
		SDI	SMPTE-425M
	SMPTE-274M		1080p (30 / 29.97 / 25 / 24 / 23.98)
			1080i (60 / 59.94 / 50)
	SMPTE-296M		720p (60 / 59.94 / 50)
	ITU-R BT.656	576i (50)	
SMPTE-125M	480i (59.94)		
Audio Format	48KHz sync		
Power	≤3W		
Working Voltage	DC 6-18V		
Working Environment	Temperature: 0℃-+70℃, Humidity:10%-90%		
Dimension	98.5×84.15×29 mm		
Net weight	200g		

### 6. Maintenance

1. Please do not disassemble the product by yourself.
2. Keep the product away from rain or moisture.
3. Please use the provided power adapter and if you use third party power adapter, please make sure the voltage range, supplied power, and polarity of power lead are fit.